

linear dimension(Tolerances Standard GB/T 14486-2008)								— ▧ ⊥		
variable range	to 6	over 6 to 10	over 10 to 30	over 30 to 60	over 60 to 100	over 100 to 160	over 160 to	to 10	over 10 to 100	over 100 to
tolerance	±0.20	±0.30	±0.50	±0.70	±1.00	±1.30	±1.60	0.10	0.30	0.60

REVISION RECORD				
REV.	DESCRIPTION	ECN No.	APPROVED	DATE
A	新发行		CLF	21.12.10

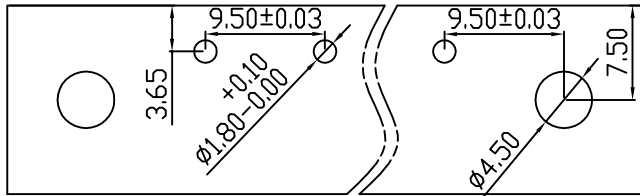

PCB LAYOUT

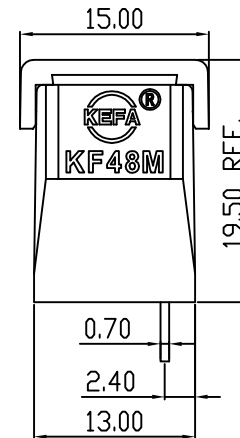
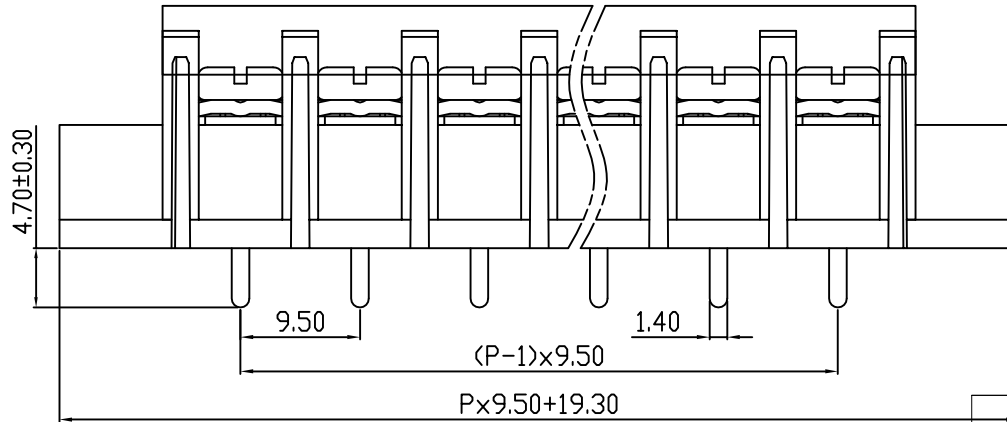
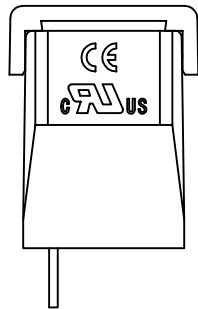
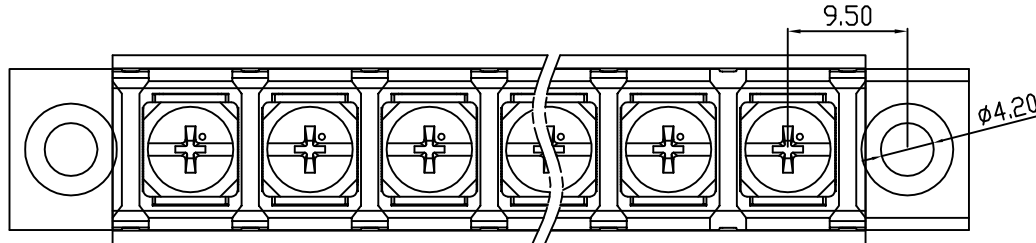

UL/CUL 技术参数		UL/CUL Technical Data					
等级	Use Group						
额定电压	Rated Voltage [V]	300	-	-			
额定电流	Rated Current [A]	20	-	-			
接线范围	Wire Range						
单/多芯线	Solid/Stranded [AWG]				22-12		
IEC 技术参数		IEC Technical Data					
额定电压	Rated Voltage [V]						
额定电流	Rated Current [A]	32					
耐电压	Withstanding Voltage	3000V/1Min					
导线截面积	Conductor cross section				4.0		
硬质/柔性导线	Solid/flexible [mm ²]						
材料		Material					
绝缘材料	Insulation Material	PA66					
阻燃等级	Imflammability	UL94V-0					
导体材料	Contacting Material	铜合金 Copper alloy					
导体表面镀层	Contactive Coating	镀锡 Tin plated					
一般参数		Other Data					
间距	Pitch [mm]	9.5					
极数	Poles [P]	02-24					
剥线长度	Stripping Length [mm]	-					
螺丝	Screw/扭矩 Torque(Max) [N.m]	M4/1.0					
工作温度	Operating temperatur [°C]	-40~+105					
引针尺寸	Pin Dimensions [mm]	4.7					
PCB板孔径	PCB Hole Diameter [mm]	1.8					

cisconn
Http://www.cisconn.com

深圳市新世联电子有限公司
TEL:+86(755)29912370 FAX:29912372

Tolerance Unless Otherwise Specified		Title		9.5mm间距 栅栏式接线端子加盖			
.X ~ ±0.30		Units mm	Scale 1:1	REV NO. V0	Material No.		
.XX ~ ±0.25							
.XXX ~ ±0.20		Date	Reviewed By	Date	Approvai By Date		
Angle ~ ± 3°					LiuYang 2023/06/01		