

linear dimension(Tolerances Standard GB/T 14486-2008)								—	\square	\perp
variable range	to 6	over 6 to 10	over 10 to 30	over 30 to 60	over 60 to 100	over 100 to 160	over 160 to	to 10	over 10 to 100	over 100 to
tolerance	±0.20	±0.30	±0.50	±0.70	±1.00	±1.30	±1.60	0.10	0.30	0.60

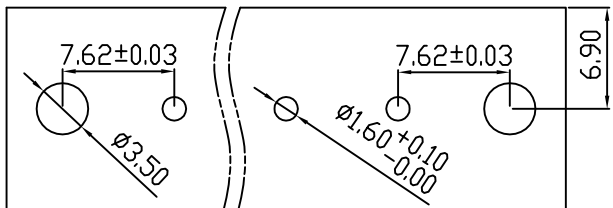

PCB LAYOUT

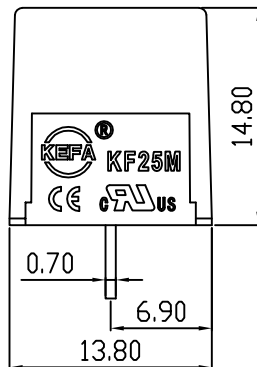
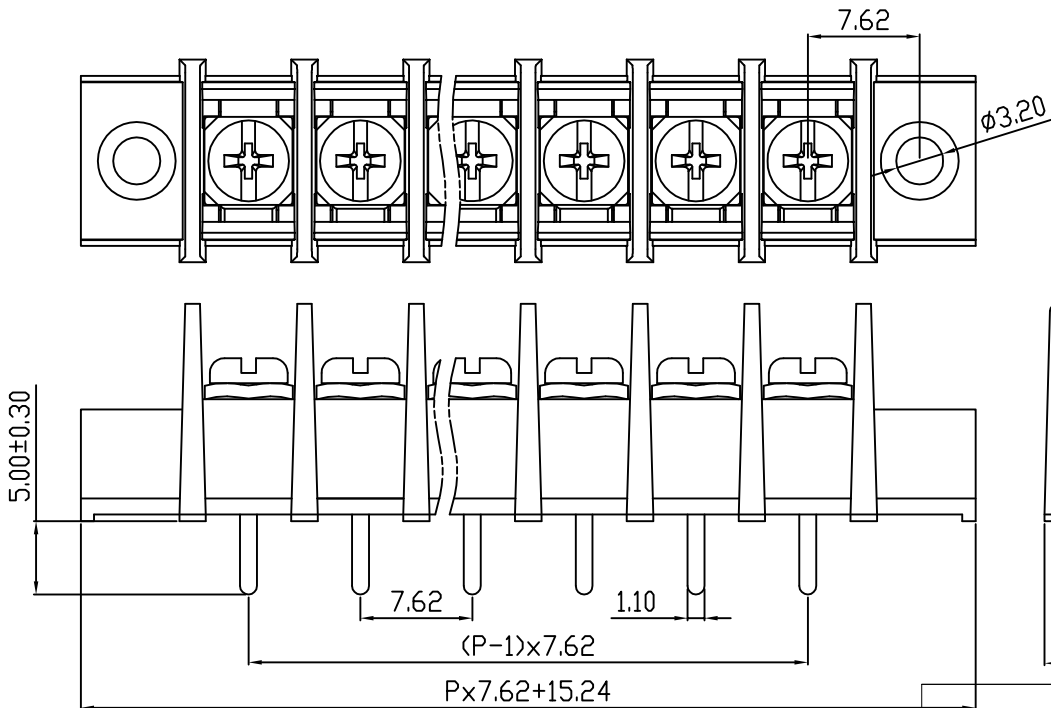

REVISION RECORD				
REV.	DESCRIPTION	ECN No.	APPROVED	DATE
A	新发行		CLF	21.10.12

UL/CUL 技术参数 UL/CUL Technical Data				
等级 Use Group		B	C	D
额定电压 Rated Voltage [V]		300	-	-
额定电流 Rated Current [A]		20	-	-
接线范围 Wire Range		22-12		
单/多芯线 Solid/Stranded [AWG]				
IEC 技术参数 IEC Technical Data				
额定电压 Rated Voltage [V]		250		
额定电流 Rated Current [A]		24		
耐电压 Withstanding Voltage [V/1Min]		2000V/1Min		
导线截面积 Conductor cross section		2.5		
硬质/柔性导线 Solid/flexible [mm ²]				
材料 Material				
绝缘材料 Insulation Material		PA66		
阻燃等级 Inflammability		UL94V-0		
导体材料 Contactor Material		铜合金 Copper alloy		
导体表面镀层 Contactive Coating		镀锡 Tin Plated		
一般参数 Other Data				
间距 Pitch [mm]		7.62		
极数 Poles [P]		02~24		
剥线长度 Stripping Length [mm]		-		
螺丝 Screw/扭矩 Torque(Max) [N.m]		M3/0.8		
工作温度 Operating temperatur [°C]		-40~+105		
引针尺寸 Pin Dimensions [mm]		5.0		
PCB板孔径 PCB Hole Diameter [mm]		1.6		

[Http://www.cisconn.com](http://www.cisconn.com)

深圳市新世联电子有限公司
TEL:+86 (755) 29912370 FAX:29912372

Tolerance Unless Otherwise Specified		Title	7.62mm间距 栅栏式接线端子		
.X ~ ±0.30		Units mm	Scale	REV NO.	Material No.
.XX ~ ±0.25			1:1	V0	
.XXX ~ ±0.20	Drawing By	Date	Reviewed By	Date	Approvai By
Angle ~ ± 3°					